

Lid

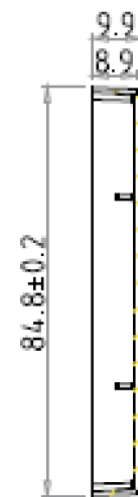

Plate

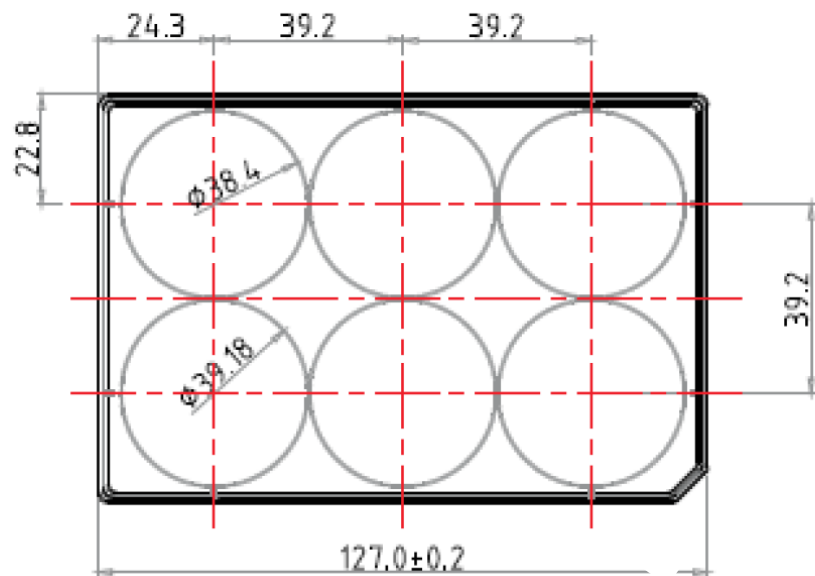
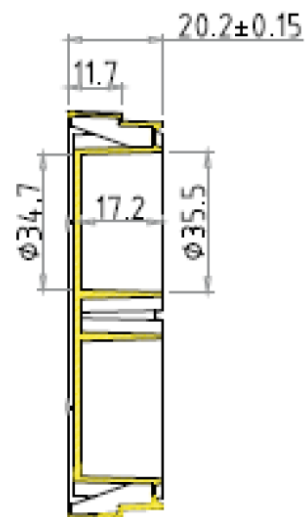
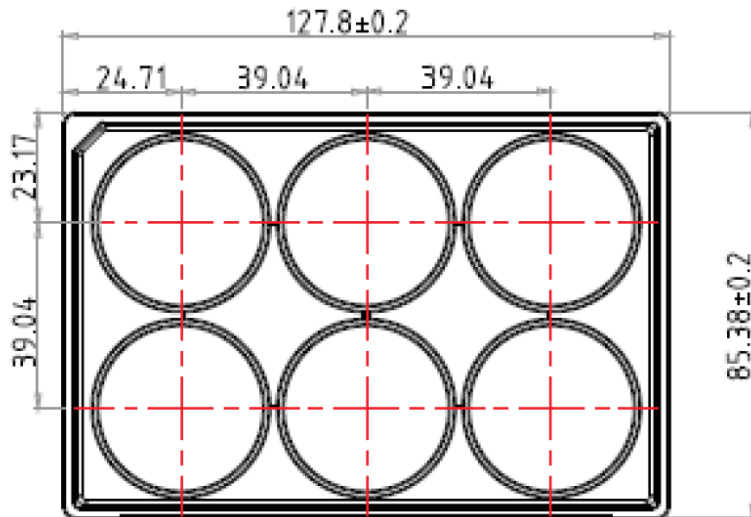

Notes: Cell growth area per well: 9.60 sq cm  
Recommended working volume: 2-5mL  
Total well volume: 16.3mL  
Overall Plate height with Lid: 23.0mm  
Well bottom thickness: 1.5mm

Dimensions in mm

 **CELLTREAT**  
SCIENTIFIC PRODUCTS

6 Well Plate  
7/2/20, KG